

UMN_00094400

User Manual Antenna Simplex



Aggiornamenti

Revision N°	Date	Owner	Notes
1	02/03/2017	T-Media	First Release









Indice

Aggiornamenti.....	2
INTRODUCTION.....	4
Symbols in this manual	4
Technical Specification.....	5
Componenti del sistema.....	6
Warranty.....	7
Installation	9
Safety Instruction for Installation	9
Dish Assembly.....	10
Arm Focus Tuning	11
Antenna Installation	12
Passage of the cables.....	13
At this point the antenna installation will proceed in the vehicle. Had it not been executed yet, be sure to fully sealed waterproof box or previously mounted cable guide.....	15
Installation of the BeepBox control box	16
Electrical Connections.....	16
How to connect the Set Tob Box	18
USE of the SIMPLEX system	20
Description of the system.....	20
Switching ON	21
Switching OFF	21
Closing the Antenna	21
Satellite Search.....	22
SatBeeper Connection	22
Antenna Inclination	22
Search.....	24
Protezione Motori	25
HOW TO UPDATE THE RECEIVER CHANNELS.....	25

INTRODUCTION

Symbols in this manual

	Read the Manual.
	Respect indication to avoid risks for user.
	Only qualified person of TECHNO-MEDIA srl.
	Pay attention.
	Correct.
	Wrong.



Technical Specification

Dish	Offset Dish with three possible dimension: 40, 65, 80cm		
Search Mode	Manual		
Power Supply	Min 11V	Typ	Max 15V
Current Sink	Min 0mA	Typ 20mA	Max 1A
Weight	4.3 Kg		
Protection Fuse	2A		
Dimension with dish closed	Altezza 21cm	Larghezza 60	Profondità 80

Componenti del sistema

Inside the box you will find:



Simplex Antenna SAT-TV 40 or 65 or 80 based on what you purchased.

Control BeepBox



5 Meters Ethernet cable to connect the Antenna and The Beep Box.



Coaxial cable to connect the antenna to the Set Top Box.

SatBeeper



Short Coaxial Cable to connect the sat beeper to the set top box or decoder

Warranty



Both Electronics and Mechanical parts are covered for 2 years. **

** European Warranty.

Keep copy of the purchase document (without this document we could not proceed with a warranty repair).

Cost of the parts and works are covered by the warranty.

Shipment and risk for the transportation are customer costs.

Under a valid warranty we will proceed to renew the system with the latest modification.

The replaced parts will not be returned.

The antenna warranty will be extended for an additional three (3) months and only on the same defect.

If the validity of the warranty and in need of repair, bring the antenna to one of our authorized service center. If there is no service center in your area, please send the antenna in its original packaging at TECHNO-MEDIA srl. with a detailed explanation of the defect. For added traceability, it is required to send an email to: info@techno-media.it



Exclusions and termination of the warranty

Are expressly excluded from the warranty all those faults that are attributable (at the discretion of the TECHNO-MEDIA Ltd.) to:

- Improper installation, misuse, neglect.
- Tampering or antenna opened by the user or unauthorized personnel.
- Failures that are attributable to an incorrect antenna use.
- Use of non-original parts.
- Failures caused by adverse weather conditions such as lightning, hail and strong wind.
- Failures caused by supply voltage or incorrect connections.



Installation

Safety Instruction for Installation

It is needed to pay attention to the following guidelines in order to avoid damage to the people who will operate the installation.



Since the antenna will (in most cases) mounted on the roof of the vehicle and this being an operation at risk of falling for the operator, you will need to take all preventive measures to avoid harm to people involved in the assembly. It must also check that the capacity of the vehicle roof is able to support the weight of the trader and tools needed during installation.

Be sure that:

1. Antenna and its parts are not powered during installation.
2. People involved does not suffer from Vertigo.
3. There is no risk to fall down from the roof or from the aids used to reach it.
4. Do not stand in a risky position where tools or material can fall down during the installation.

Dish Assembly

Dish is separated by the main body during shipment.

To install it a single Phillis screw driver is needed. Screws are screwed on the main body and must be removed before installation.

Place the main body on a stable and flat surface

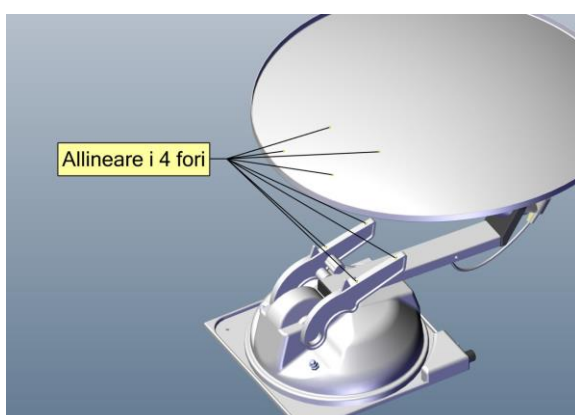
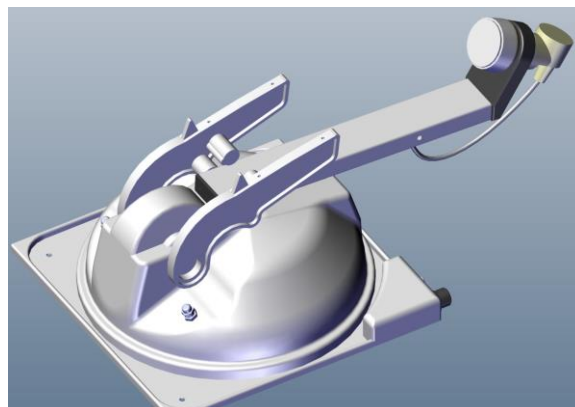

Align the 4 holes on the Dish with the four holes on the two support on the main body

Align the 2 plates with the dish and the main body

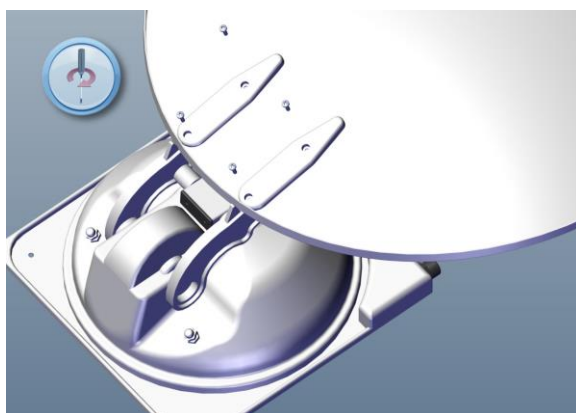
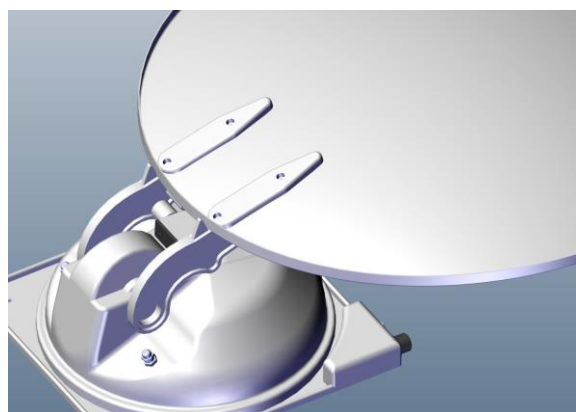

Set the four screw firmly

Arm Focus Tuning

In case of problems pointing a satellite, it is possible that a tuning of the arm/dish angle is needed.

In case of that:

- Switch on the Set Top Box
- Switch On the Antenna pressing the ON button
- Wait until the antenna start the horizontal rotation.
- Press the OFF button



Measure the distance from the hole close to the edge of the dish

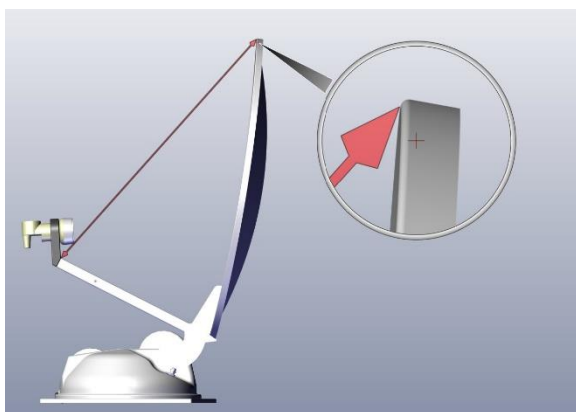

Now switch ON again the Antenna and wait for the complete process.

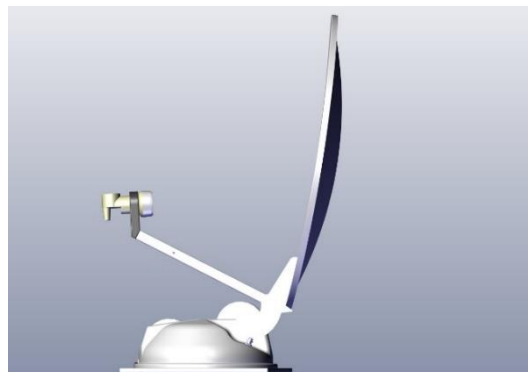

With a screwdriver , turn the screw shown in the picture in order to set the distance between the edge of the dish and the arm to **67 cm** for the dish of 65cm and **86 cm** for the one of 80cm

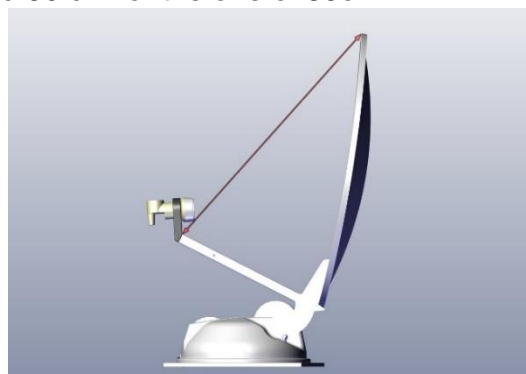

To the junction between the arm and the plastic of the LNB handler.

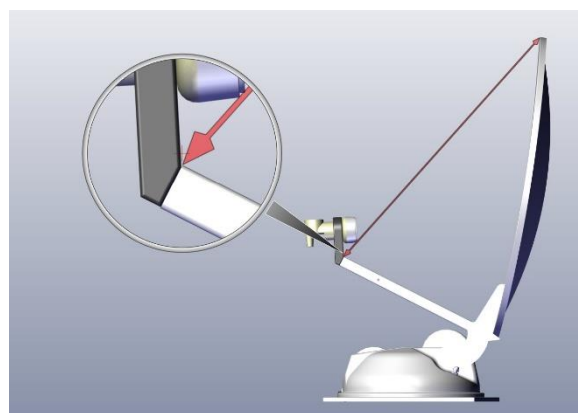

Antenna Installation

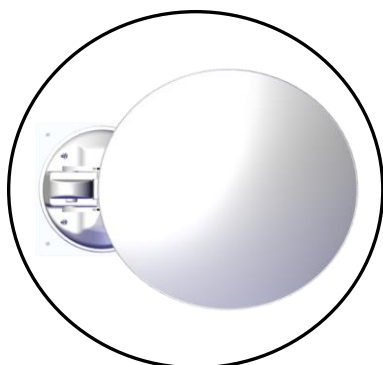

Verify that there is enough space on the roof of the vehicle in order to allow the antenna movement. The antenna always opens first vertically and then horizontally to allow you to reduce the overall operating conditions but, in far south regions, such as Morocco or North Africa, to point the antenna of some satellites could tip very back, so it is necessary that there are no objects that prevent its rotation.

Consider a space of about 130 cm in diameter around the antenna as shown.

Thoroughly clean the area identified for fitting and removing all traces of grease, dust and debris.

With a caulking gun, apply a uniform layer of polyurethane adhesive on the baseplate of the antenna body (Area 1). Refer to the operating instructions of the adhesive used. Use adhesives compatible with the counter material (ABS) and the roof of your vehicle.

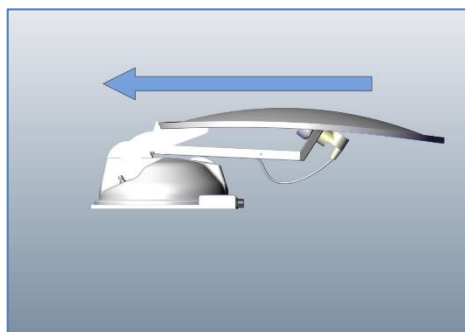
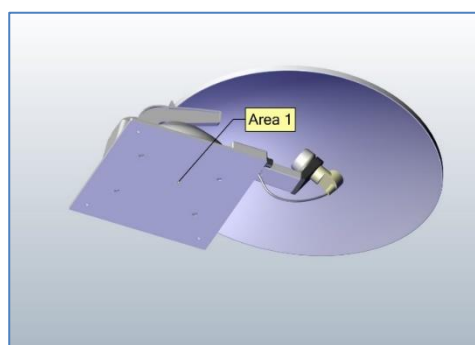

Then position the antenna in the above cleaned area by paying attention to the direction. The arrow in the figure indicates the direction of march of the vehicle.

Be sure that the antenna is parallel to the sides of the vehicle.

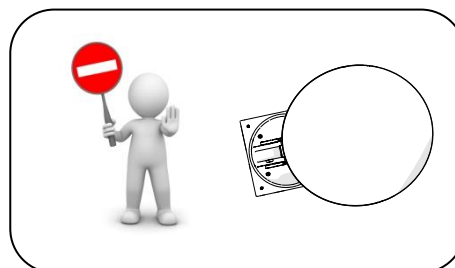
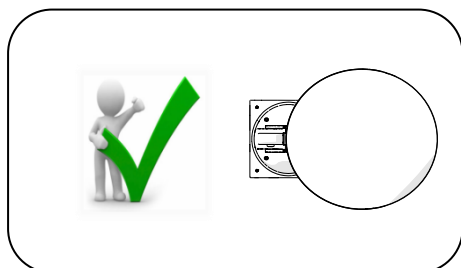

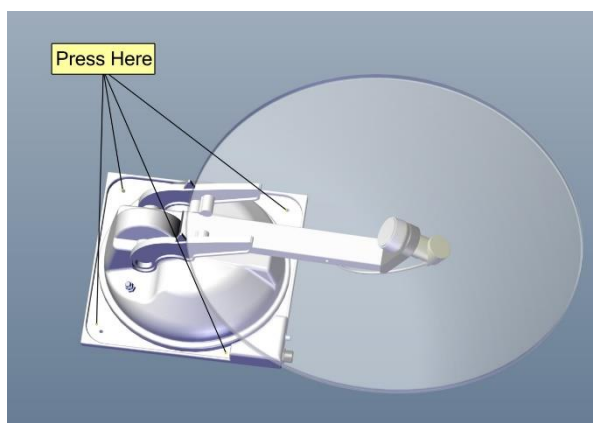

Press firmly on all four corners of the aluminum plate and at the center of the cap as indicated by the figure. **Do not press** above the parabola to prevent warping it. This will irreparably damage the mechanics.



Select a suitable adhesive to fix the baseplate ABS to your roof.



Follow the instructions from the manufacturer of the glue and in any case, let it rest at the appropriate temperature (see manual glue instructions) for at least 24 hours before starting move the vehicle.

Passage of the cables

If it was not already, make a hole for the passage of the two cables required to the antenna operation.

After making the hole, fit the weatherproof box or the cable guide.

Run the two cables supplied in the kit if necessary with the help of an electrician's probe, if you were to encounter resistance, **DO NOT** pull on the cables, you might run into the cable break and then the antenna malfunction. Such failure is not covered by warranty.

Ethernet cable 5 meters NOT cross

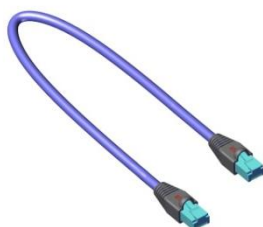

Antenna
Coaxial cable 5 meters



Leave a sufficient cable length between the cable guide and the antenna so you can reach the connectors on the antenna connection body without bending too close or keeping in tension cables.

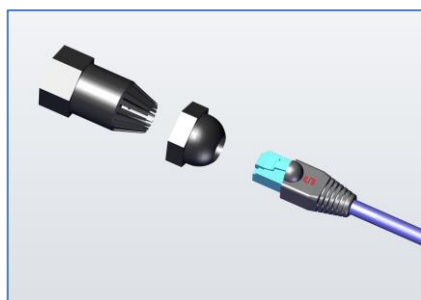
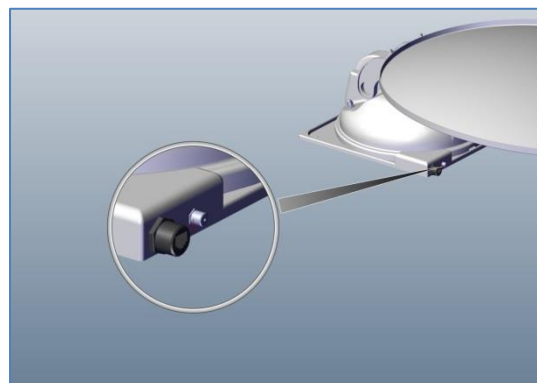

If not already assembled, install the seal and plastic cap on the end of the Ethernet cable which is then connected to the antenna:

First plug the Ethernet cable into the side of the guard as shown in the figure, first the rear and then plug in the casing front.

Once the cable is into the two parts, open the rubber gasket provided and let it fit around the ethernet cable.

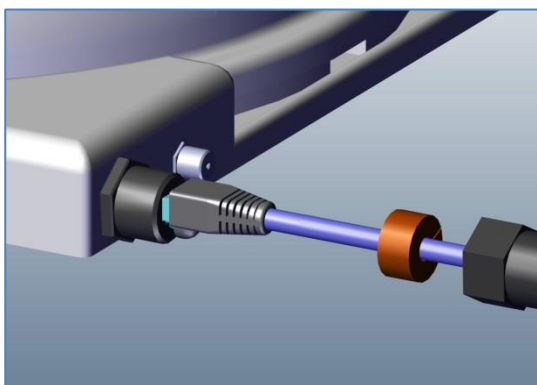
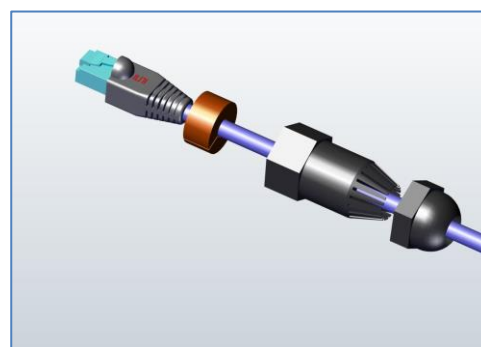

Connect the RJ45 connector of the Ethernet cable to the antenna connector, as shown in the figure, insert the connector until the retaining tab does not Click

Move the seal close to the connector

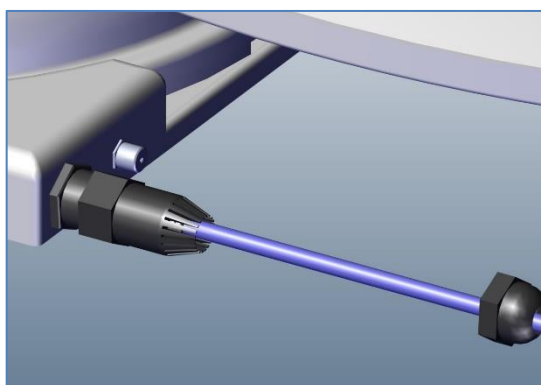
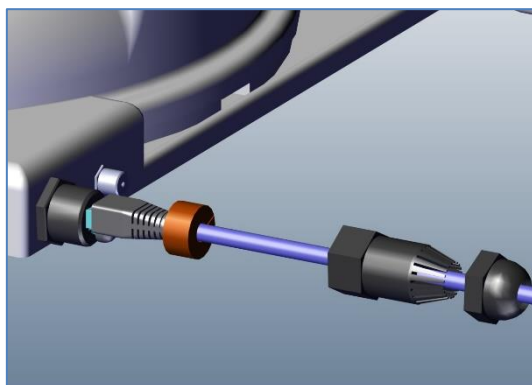

Screw the connector body as shown in the figure. Perform the operation carefully avoiding to turn the other party on the dome. **Do this by hand without the use of tools, it is not necessary to tighten too hard.**

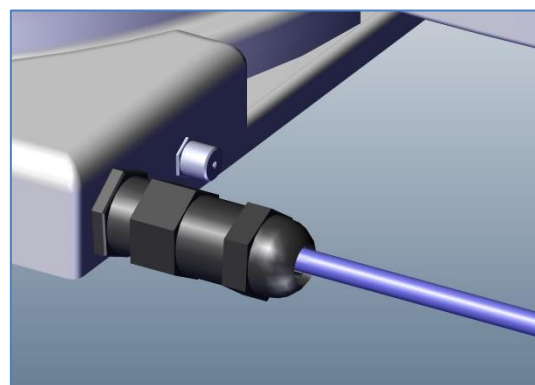

Screw the last part on the body of the connector so that the gasket is contained inside avoiding infiltrations of water. **Do this by hand without the aid of tools, it is not necessary to tighten too hard**

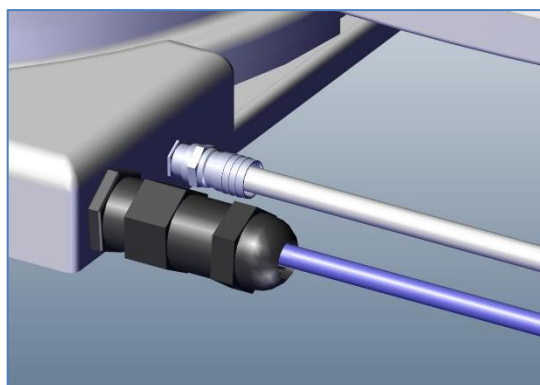

Proceed at this point to the antenna cable connection. Be careful not to rotate the antenna connector on the body.



At this point the antenna installation will proceed in the vehicle. Had it not been executed yet, be sure to fully sealed waterproof box or previously mounted cable guide.

Installation of the BeepBox control box



The control and power supply box supplies power to the antenna when you press the ON button or when the vehicle is set in motion. It allows you to close the antenna and to program the type of decoder used.



Install the Beep-Box leaving adequate ventilation to prevent electronics failures.

Electrical Connections

After identifying the position and set the controller to the wall, proceed to connecting all the wires of the same as shown below:

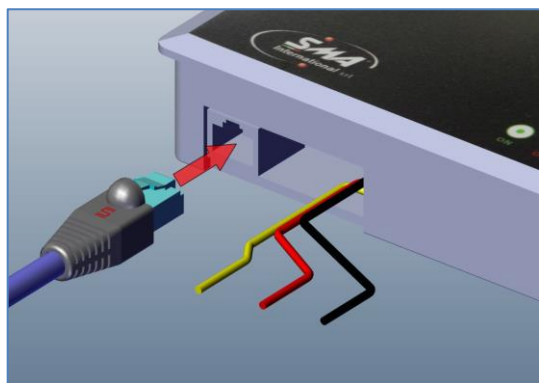

Plug the RJ45 connector from the antenna on the roof of the vehicle in its connector, as shown in figure until you hear the click of the retention clips.

At this point you can proceed to the connection of the power cables.



Even if the voltages involved are quite low, pay attention to avoid shorts and invert connections.

1. Connect the **BLACK WIRE** to the negative of the battery or to the vehicle chassy
2. Connect the **RED WIRE** to +12V of the Battery.
3. Connect the **YELLOW WIRE** to a 12V line which is powered only when ignition key is turned or the vehicle is ON.

Refer to the below picture

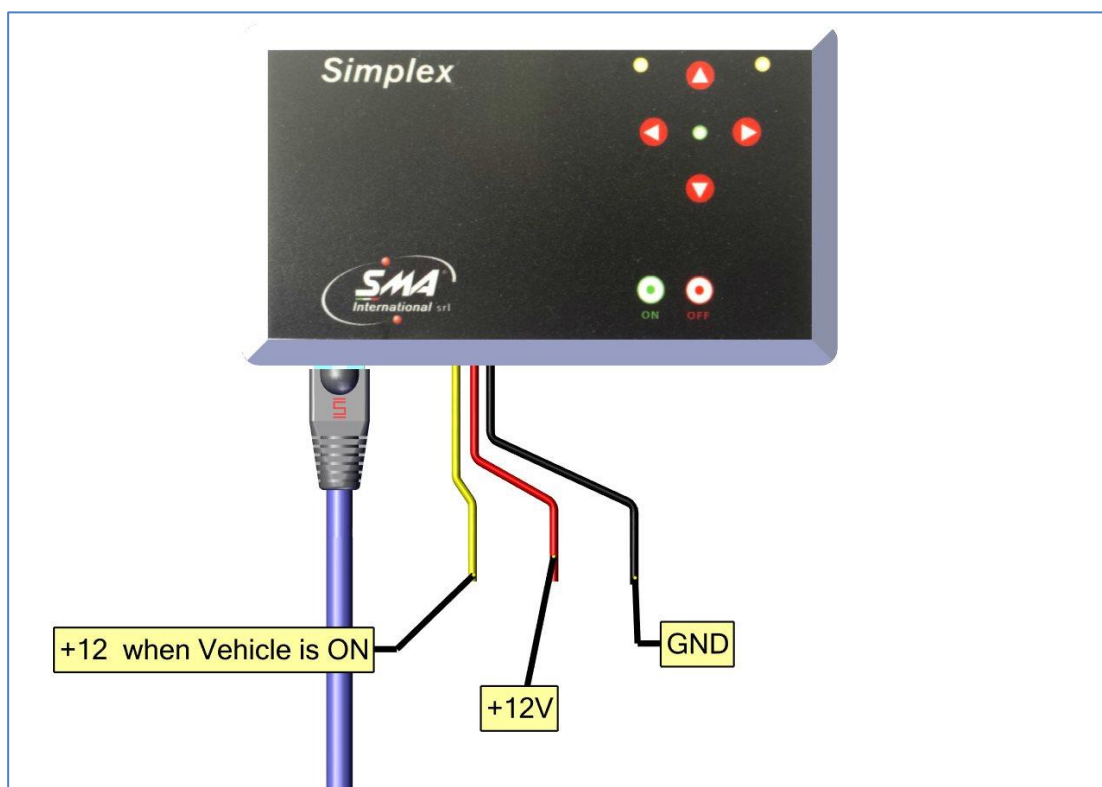

How to connect the Set Top Box

Connect the short coaxial cable to the RF IN of your Set Top Box.

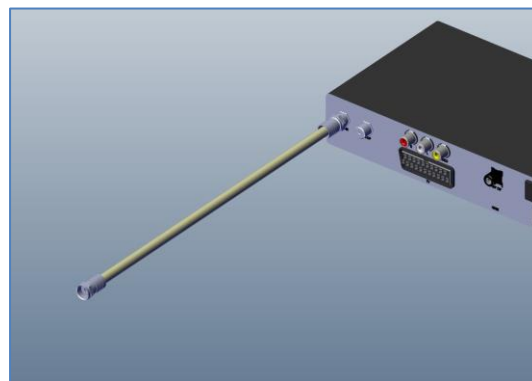
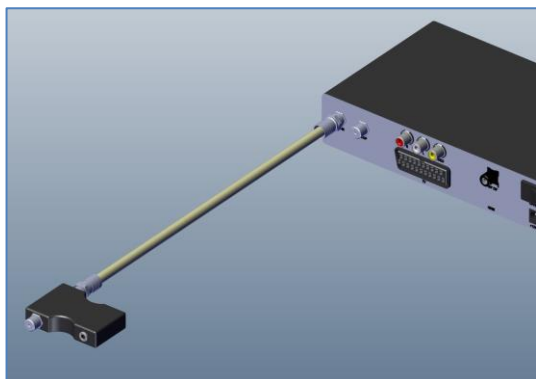

Connect the RF OUT of the Sat Beeper to the cable coming from the set top box

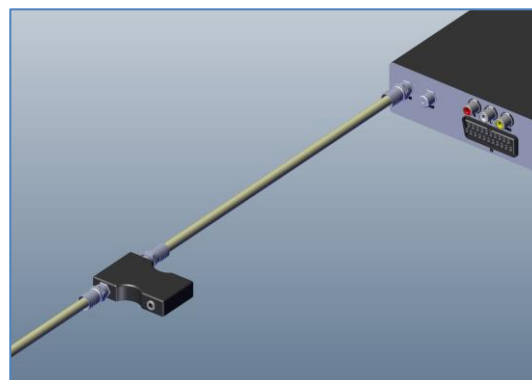

Connect the coax cable coming from the antenna to the RF-IN of the satbeeper. The satbeeper can remain connected even when not used



Connect your TV to the set top box using a suitable cable, SCART-SCART or HDMI.

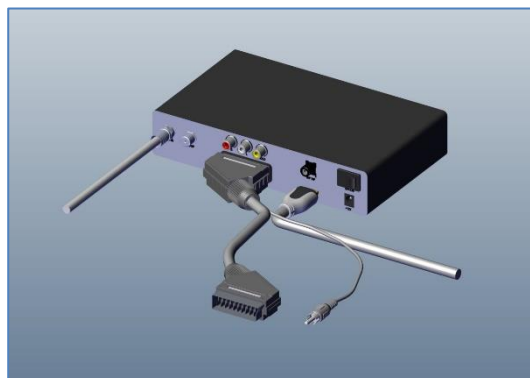

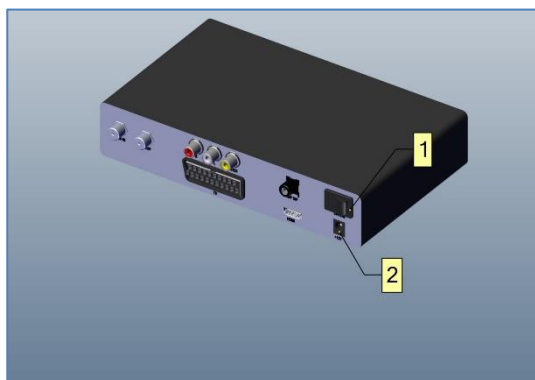

All the connections have been made.
You can power up the set top box.
Connect the power cord to the Set Top
Box [2] and if the system has one, turn
on the switch [1]

USE of the SIMPLEX system

Description of the system

Simplex Antenna can search the satellite only through the intervention of the user



System is designed to work with any Set Top Box. Anyway there are Set Top Boxes like SKY and/or PAY PER USE which require longer time to lock the signal. For this reason, if your receiver is one of those, you need to wait longer time before the signal is decoded properly.

Switching ON

To power on the antenna press the ON button on the Beep-Box.

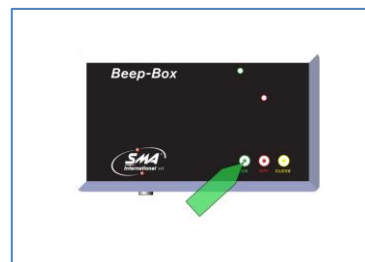

Switching OFF

To power on the antenna press the OFF button on the Beep-Box. This allow to reduce to zero the current consumption after pointing the satellite.



In case of strong wind proceed to close the antenna in order to avoid damage to the system and to the roof of your vehicle.

Closing the Antenna

Antenna can be closed in two different ways

1. Manually



Close the antenna first rotating it and then closing it down.

2. Switching ON the vehicle

- For safety reasons, when the vehicle is switched on or the Ignition KEY is turned, the antenna will close automatically (yellow cable MUST be connected). A continuous beep will be sound until the antenna is in movement, does not move the vehicle until the beep is present.

Satellite Search

SatBeeper Connection

The SatBeeper allow to check the signal strenght during the pointing process.

TO do that, connect the headset to the satbeeper as shown in the picture

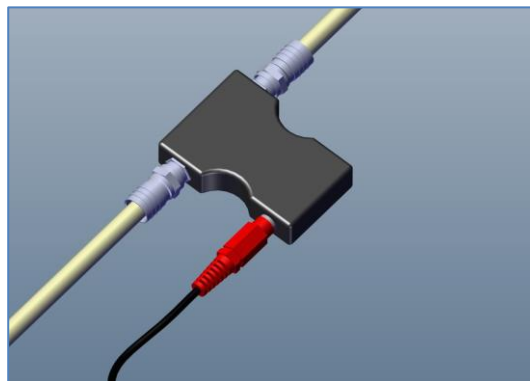

Antenna Inclination

Before to start the rotation, it is important to rise up the antenna with an inclination which is the right one to point the needed satellite. Inclination is a key parameter to point his antenna and your latitude and longitude is a factor which define it.



First Open vertically the antenna and then start rotation

Higher is your latitude and more vertical should stay the dish.

Check the example in the following page as a reference

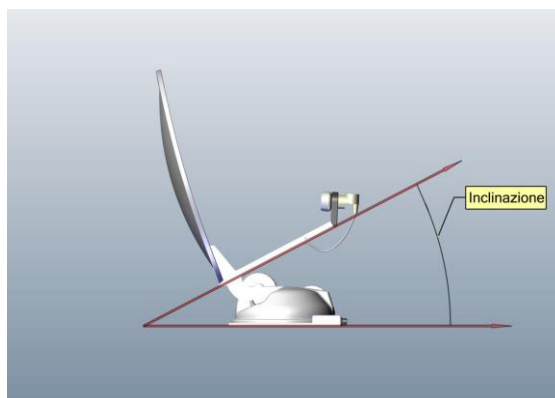

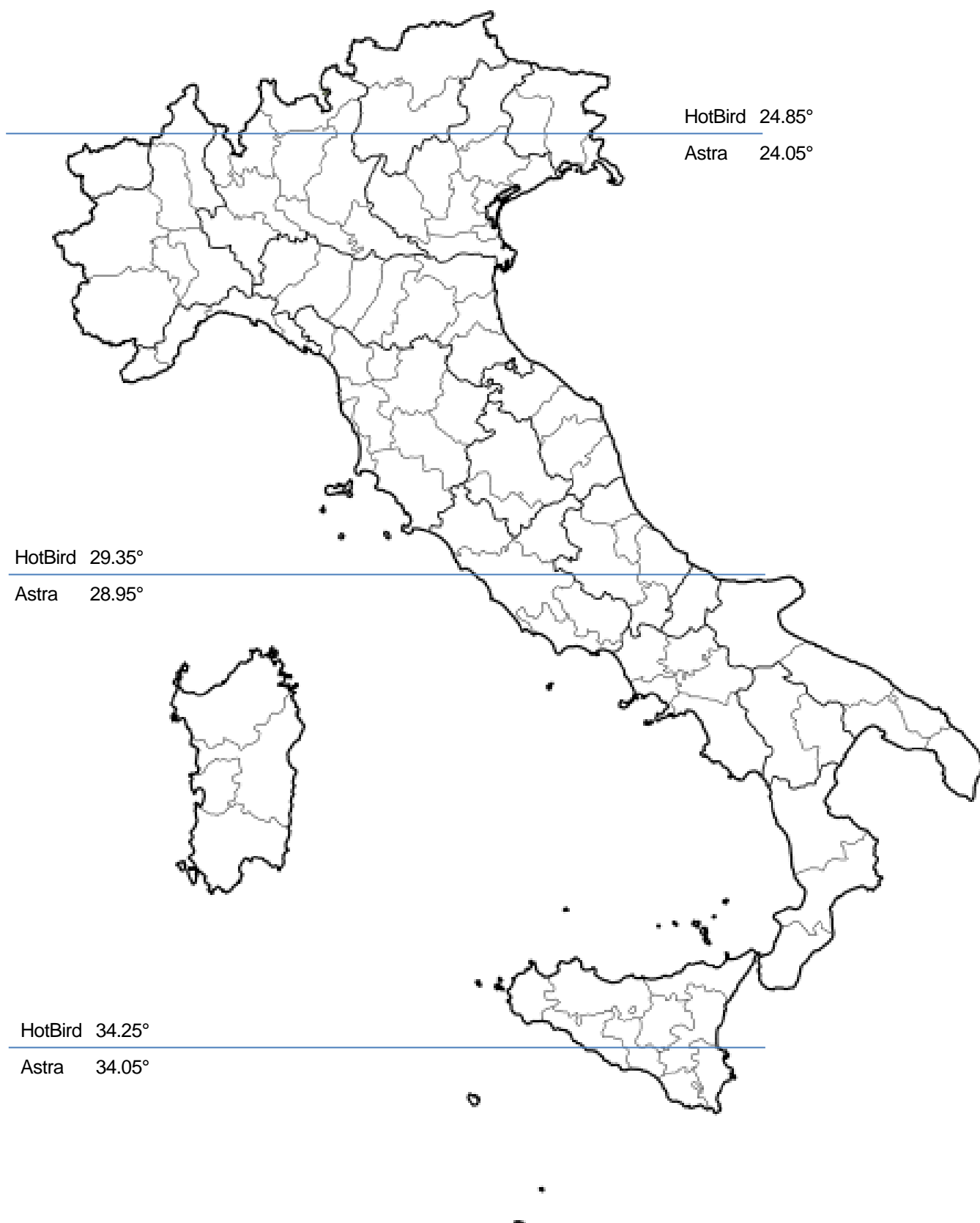

Search

After setting the vertical position, proceed with the rotation

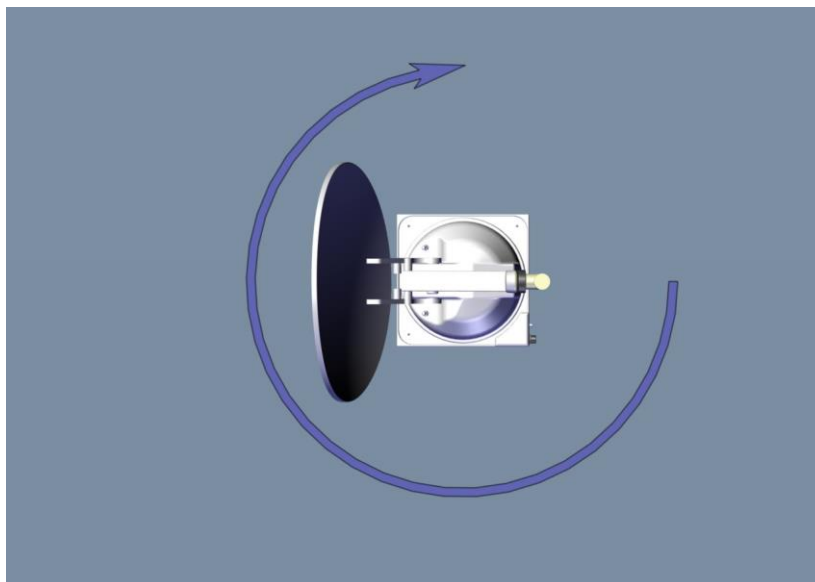

If the inclination is correct, as soon as the dish move in the satellite direction you will hear increase the frequency of the satbeeper

Find the best position moving forth and back the antenna

Now move up and down the antenna to increase the signal strength.

If the satellite is the right one after few seconds the image will appear on the TV, if not repeat the process pointing a second one.

Protezione Motori

If an obstacle is within the movement range of the antenna blocking the turning or rising movement, the system will be switched off. To restart the system remove the obstacle and switch the antenna on again.



Take all necessary precautions if you must get on the vehicle roof. Avoid using metal rods for the removal of obstacles when weather conditions are adverse.

HOW TO UPDATE THE RECEIVER CHANNELS



As explained in the previous chapters, SAT-TV-40-65-80 is able to point the satellite only if the user operate correctly.

Does not start the channel update if you are not sure to pint the right satellite

Follow these points in order to update your receiver:

1. Point correctly the satellite
2. Press OFF button on the BeepBox version



During the Set Top Box update process, do not operate any button on the Beep Box, do not switch on the antenna and do not turn on the Ignition Key

3. To start the update process refer to the Set Top Box user manual..
4. Switch on the Antenna only at the end of the Set Top Box update process.



UMN_00094400

User Manual